



After 25 years of experience, INDUPANEL keeps investing in new designs, research and development, and new technologies to offer the ultimate solutions for such an important feature as like the entrance door of your home.

A front door defines the house personality, a distinctive element full of symbolism, a state of the art.

DOORBLOCK is a high-end product, consequence of our experience and evolution, defining an exclusive and personal choice.

At entrance doors, INDUPANEL goes further.



DOORBLOCK is a complete door system developed by **INDUPANEL**, integrating both the panel **door** (in a wide range of designs, dimensions and finishes), such as **frames** (one or two sidelights, or upper side may be optionally added), and all kinds of **accessories** (knobs, lever handles and bar handles, both standard and integrated), security **locks**, visible or hidden **hinges** and the latest in home **automation systems** (opening by fingerprint or mobile application, removing architectural barriers and facilitating access for people with reduced mobility).

Everything is fabricated using top quality materials to ensure the safety and durability of the final product, looking for the customer's maximum satisfaction.

The high thermal performance of our different cores provides an insulation and energy savings that make this system compliant with Passivhaus standards.

CORE: - POLYSTYRENE

- FINISHES:**
- RAL POWDER PAINT
 - WOODGRAIN
 - DECORATIVE FOIL
 - RESIN
 - DEKTON
 - LACOBEL
 - ANODIZED



DOORBLOCK
by indupanel

ÚNICA is **INDUPANEL'S** most special collection. Inspired by a selection of large constellations whose names come from ancient Greek and Roman mythologies, the **ÚNICA** model's collection gathers the beauty and uniqueness of the stars and aim to somehow convey an extraordinary story full of strength and splendour.

Beyond the myths, fantastic beings, divine fighting's... the objective is achieving a different perception of the front door, seeking a conceptual transcendence.

With sets of reliefs, metal-imitating resins, and ad hoc pull handles, these models combine innovation, aesthetics and their own personality.

EVERY TEXTURED DOOR IN THE **ÚNICA** COLLECTION IS MADE IN A ARTISANAL WAY AND PRESENTS A HANDMADE FINISH, SO NO TWO ARE EXACTLY THE SAME, RESULTING IN A UNIQUE AND EXCLUSIVE PIECE.

Enter a new galaxy of front doors.



ÚNICA

ALYA



ANDRÓMEDA



ANTARES



AQUILA

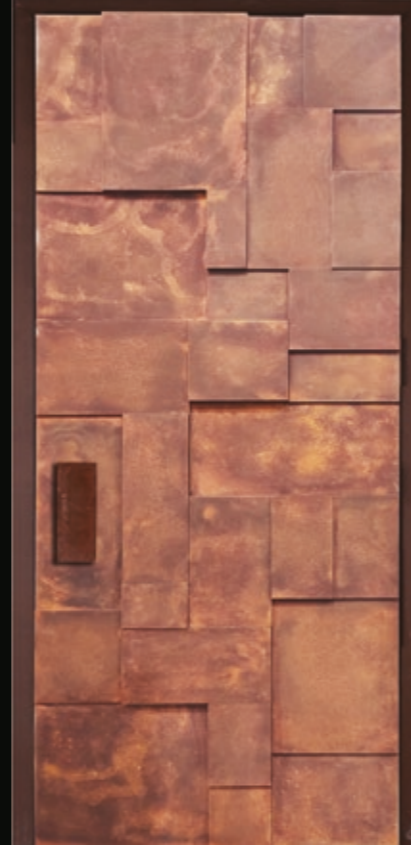

ATRIA



CASIOPEA

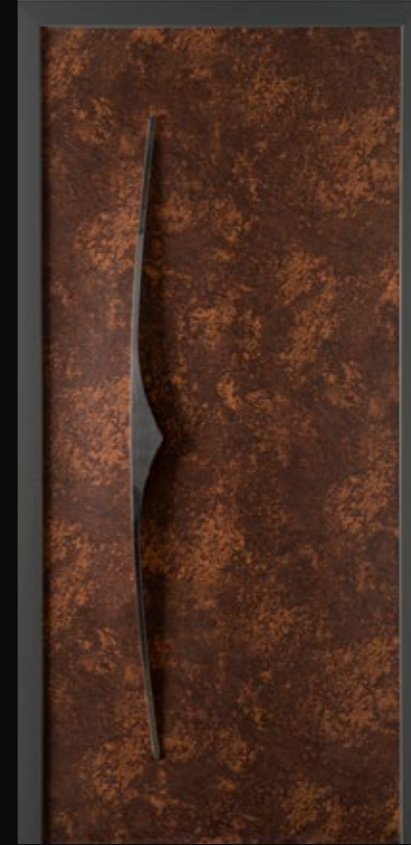

CORVUS 



CRUX



DRACO

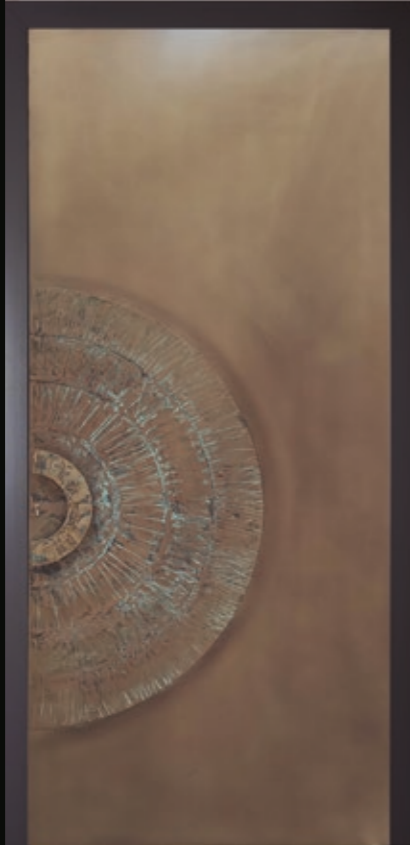

ELECTRA 



ERÍDANO



FORNAX GLACIAR

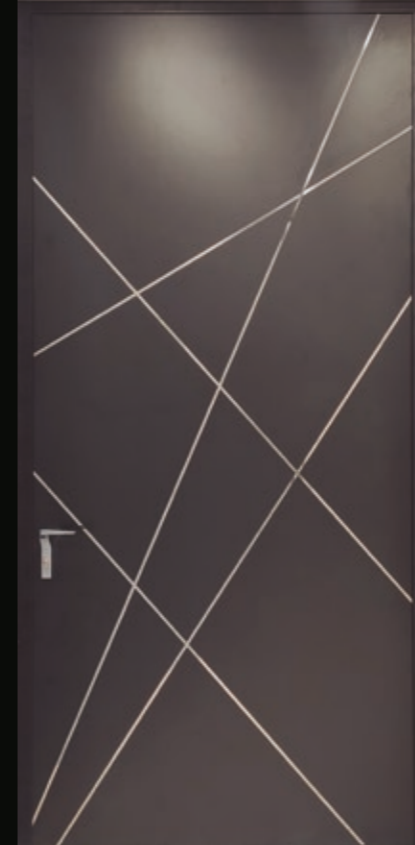

MAIA



MIZAR 

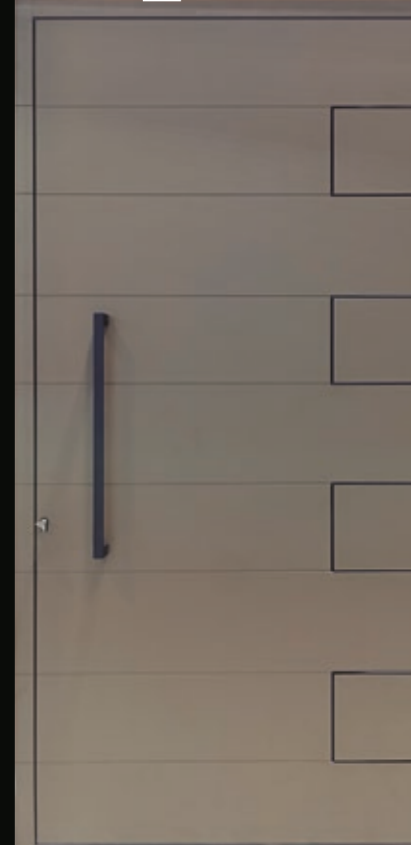



TRILIUM

INDUPANEL incorporates the latest design trends for industrial or minimalist styles, by using **DEKTON**, a surface with high resistance to UV rays and high temperatures, ice, abrasion, stains and scratches.

A wide variety of surprising colors and textures, which allow you to achieve great versatility for your project, unleashing creativity and adapting to the space you inhabit. A range of finishes with which you will achieve an incomparable aesthetic and a surprising result.



ARGA

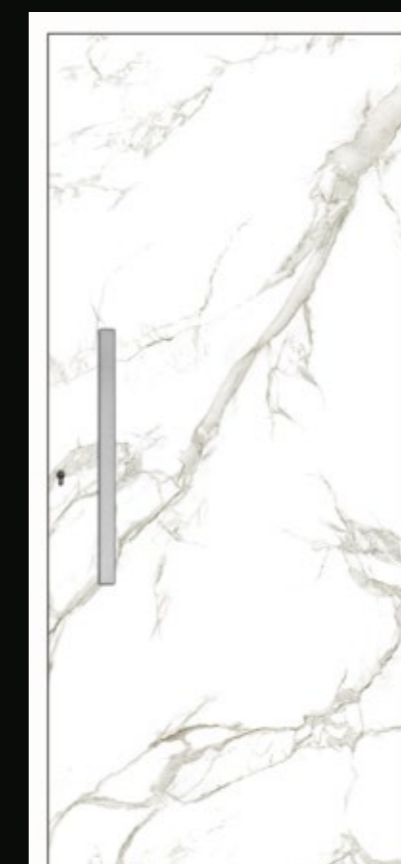

AURA15



KELYA



LAURENT

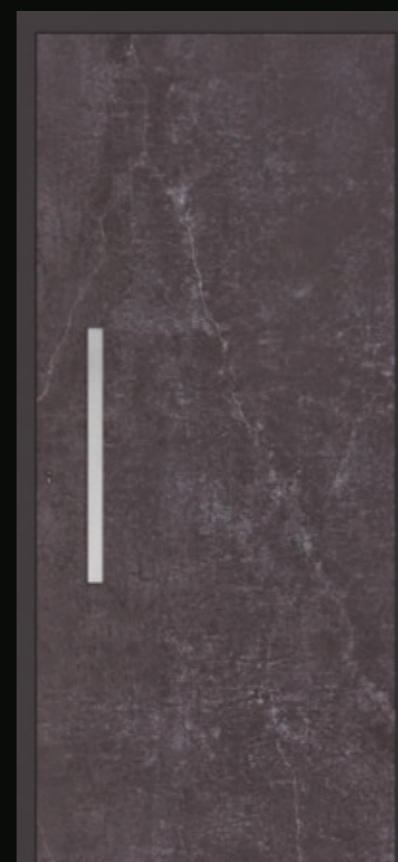

LAOS



KRETA



REM



BASIC
RAL 9016
Acc MA 10



BASIC
RAL 9016
Recessed handle



3LINE
RAL 9016
Acc MA 10



3LINE
RAL 9016
Recessed handle



3LINE - GLACIAR
RAL 9016
Recessed handle



FULLY GLAZED
RAL 7016
Acc MA 10



IP-3
RAL 7016
Acc MA 10



4LINE
RAL 7016
Acc MA 10



4LINE
RAL 7016
Recessed handle



4LINE - GLACIAR
RAL 7016
Recessed handle



LACOBEL
RAL 9005
Recessed handle

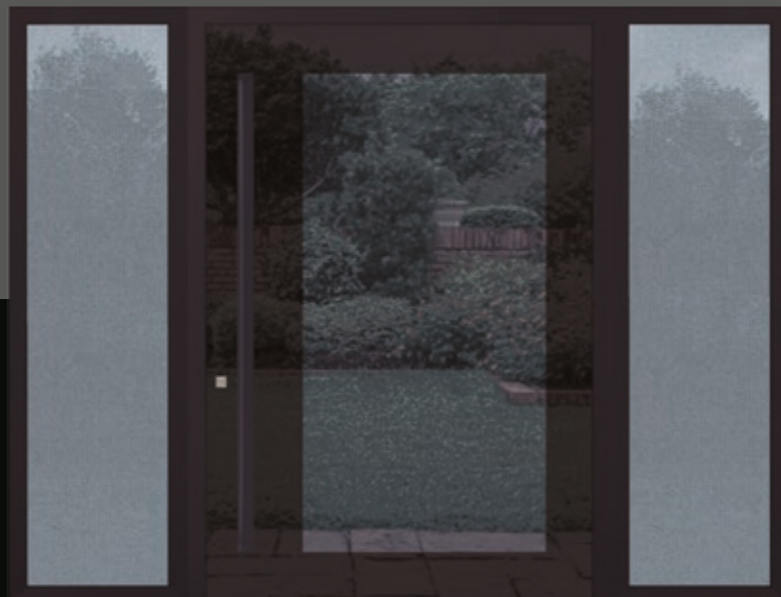

LACOBEL / GLASS
RAL 9005
Recessed handle



5LINE
RAL 9005
Acc MA 10



5LINE
RAL 9005
Recessed handle



5LINE - GLACIAR
RAL 7016
Recessed handle



A new design,
defined by a series
of enveloping
spirals that groove
the door's surface.

With a dazzling
finish, the
combination
creates a modern
and very bold door.



NEW | **ELECTRA**
Colour: Aged gold resin
Accessory: Recessed handle 9005
Details: Grooves



We've transformed the concept of a pivot door and gone one step further with this system in which the door enters the sidelight and the sidelight enters the door, creating a spectacular sense of depth.



NEW MIZAR
Colour: Earth Clay
Accessory: MA 4
Details: Interlock pivot



The combinations of this design, with central lacquered glass, on a wood or RAL finish, offer various results, all of them resplendent.

NEW CORVUS
Colour: Foil 20057005
Accessory: MA 10
Details: Lacabel Glass



ALYA RECESSED HANDLE
 Colour: Golden oak
 Accessory: Recessed handle RAL 9005
 Details: Vertical square trims 50x40 mm

This new design is influenced by the Nordic style, identified by its vertical square trims, that give it a surprising 3D shape and solid appearance.

The configuration of this model is available with a recessed handle or a standard bar handle, and even a disguised solution by having on slightly projected square trim with a side milled recessed handle.

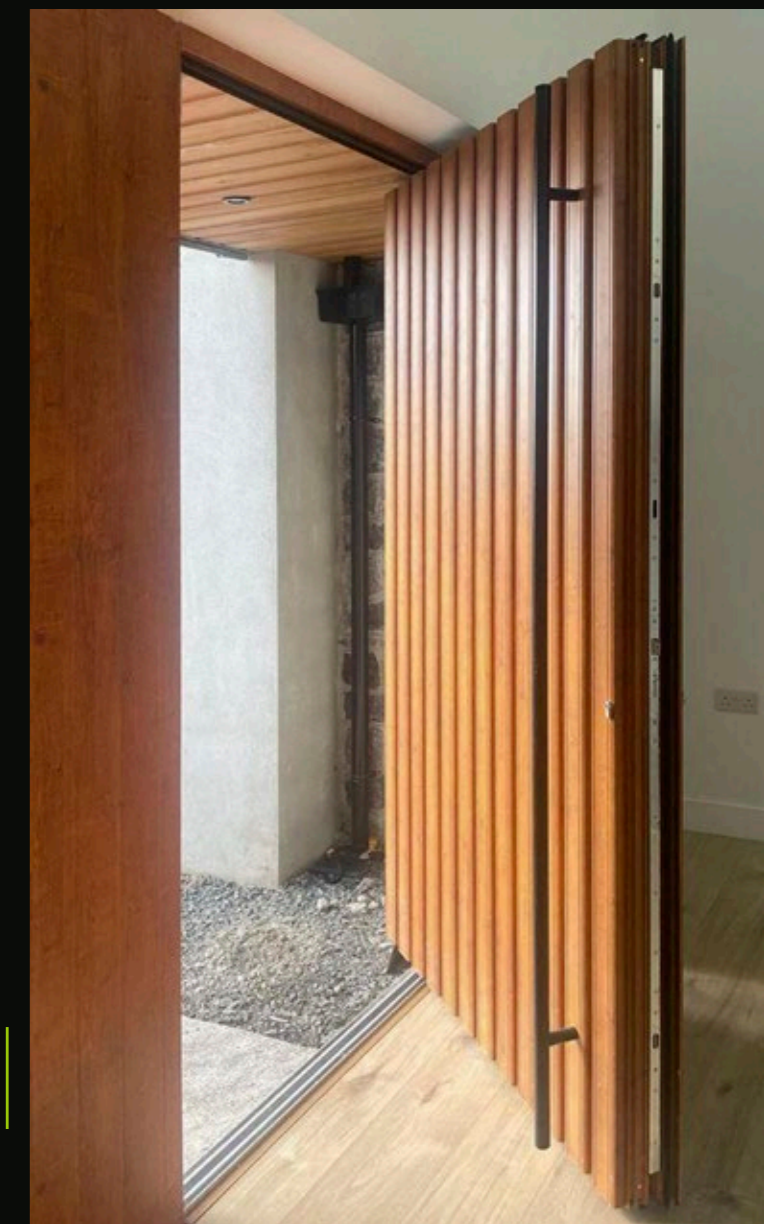

ALYA VISIBLE HANDLE
 Colour: Golden oak
 Accessory: MA 10
 Details: Vertical square trims 80x20 mm

ALYA
 Colour: Foil 4703001 / RAL 9016
 Accessory: Recessed handle
 Details: Vertical square trims 50x40 mm
 Fingerprint scanner



The versatility of the width and depth of these vertical trims, together with the combination of the different skins and trim finishes, and the available handle options, provide it a wide variety of results.

ALYA 2

Colour: Embero 802 / RAL 9005
Accessory: Recessed handle Alya 2
Details: Vertical square trims 50x40 mm



ATRIA
Colour: Foil 4703001
Accessory: Atria BROWN OXIDE

With its own integrated handle in the door skin, this new model offers multiple combinations of finishes, achieving a wide variety of results.

This pull handle is fully recessed into the door surface and has a flush metal piece which is used to pull, either from above or below.



ATRIA
Colour: Foil 4703004
Accessory: Atria RAL 9005



Another integrated handle is this MAIA model. It is recessed in the door panel, positioned horizontally, with enough space for an ergonomic grip.

MAIA
Colour: Golden oak
Accessory: Maia RAL 9005





An industrial finish imitating cement, with irregular textures, characterizes this new design.

Minimalist and sober, in neutral tones, and with a robust aesthetic, this door provides a touch of authenticity at your entrance.



CRUX
Colour: Microcement
Accessory: CRUX



FORNAX
Colour: RAL 7021
Accessory: MA II
Details: Grooves



FORNAX GLACIAR
Colour: RAL 9011
Details: Stainless steel



DEKTON AURA15
Frame: DEKTON AURA15
Accessory: SQ 10 and THUMBTURN



ANDRÓMEDA
Colour: Foil 1660857 Sahara Cement
Accessory: Recessed handle
Details: 3D piece
LED lighting



CASIOPEA
Colour: Foil 436-9024
Sahara oxide
Accessory: Casiopea

Majestic design
with a finish that simulates
oxide effect, with the pull
handle as the undisputed
protagonist.

Its large size covers a
wide part of the door, and
its slightly curved shape
provides dynamism and
ergonomics for a perfect
handling.





ERIDANO

Colour: Foil 20057004 Desert Oak
3D piece: RAL 9005
Details: Stainless steel RAL 9005

With the contrast as a purpose, this piece with organic shapes inspired by the nature, is added to create a three-dimensional experience and unique sensations to the touch.





AQUILA
Colour: Oxide resin
Accessory: UNICA 10
Details: Three-dimensional
surface

Set consisting of
overlapping pieces of
different sizes and depths,
with rough texture and oxide
imitation finish, resulting in a
powerful and eye-catching
visual style.





DRACO

Unique design
made of resin,
rough textured in a
geometric design
with the handle
and aged gold
finished





ANTARES

Made of resin, with a smooth textured part and another rough textured with a spatula effect. Finished in bronze and handle covered with python leather





LACOBEL

A spectacular finish is achieved by this lacquered glass, with a uniform shine that provides great luminosity and elegance



With smart glass option, which allows to switch between an opaque or transparent finish, simply by pressing a button.

LACOBEL / GLASS

Colour: Black Lacobel
Accessory: Recessed handle with LED
Details: Fingerprint opening



RECESSED HANDLE

Opening system with a **recessed handle**, longitudinally drawn (parallel to the edge of the panel), with an ergonomic opening for a comfortable inner hand grip, giving a clean surface to the door appearance and avoiding any overlapping elements.

This system also allows the incorporation of a LED lighting, a flexible strap that perfectly fits inside the handle and gives a dim light, providing a brilliant result to the door overall assembly.

The size and position of this handle is totally customizable and adaptable to the design of each door, either in the same panel finish or a different one to get a contrast.

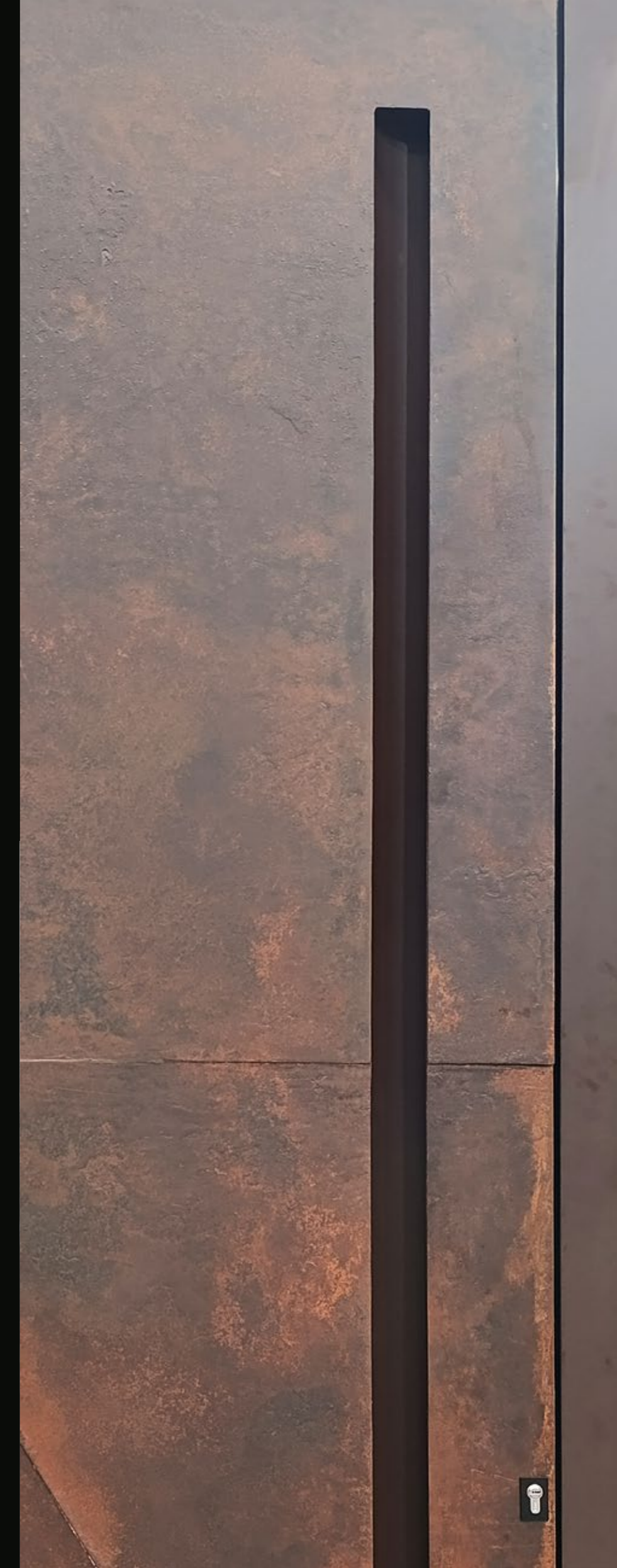

4LINE

Colour: RAL 7016
Accessory: Recessed handle
Details: Fingerprint/keyboard opening





ALYA
 Colour: Foil 474703001 / RAL9016
 Accessory: Recessed handle
 Details: Fingerprint opening

PIVOT DOOR SYSTEM PIVOT80

PIVOT DOOR SYSTEM, BONDED ON BOTH SIDES

All pivot doors come with the following basic features:

- 80 mm thickness profile
- 80 mm thickness panel
- 25 mm THICKNESS ALUMINIUM SHEET
- FLUSH PANEL WITH FRAMES BOTH SIDES
- 3 POINTS LOCK
- Glass thickness for sidelights: 32 mm (Consult other values)
- Core EPS ($\rho=30 \text{ kg/m}^3$)
- Maximum door height: 6.300 mm
- Maximum door width: 2.300 mm
- Aluminium frame and panel in powder paint finish
- Thermal seal with shear-free insulating profile (page 51)
- Safety cylinder
- Low threshold in between the side frames
- EPDM joints
- Lever handle
- Air permeability: **CLASS 4**
- Watertightness: **CLASS 2A**
- Wind resistance: **CLASS C3**
- Maximum acoustic insulation: **Rw-30 (-1; -4) dB**
- Thermal transmittance: **Uw-0'97 W/m²K**

Optional extras:

- Motorised lock, with different types of electronic openings available: fingerprint, bluetooth, code... (page 57)
- Handle: concealed (page 44), from catalogue (page 59), customized...
- High safety cylinder (page 63)
- Thumbturn (page 63)
- Hidden door closer (page 65)
- Motorised opening (page 65)
- Electronic wireless spyhole (page 65)
- Sidelight: glazed, paneled, bonded...

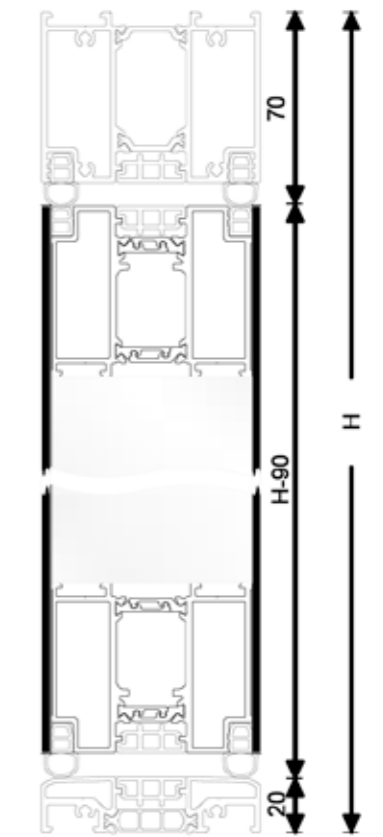
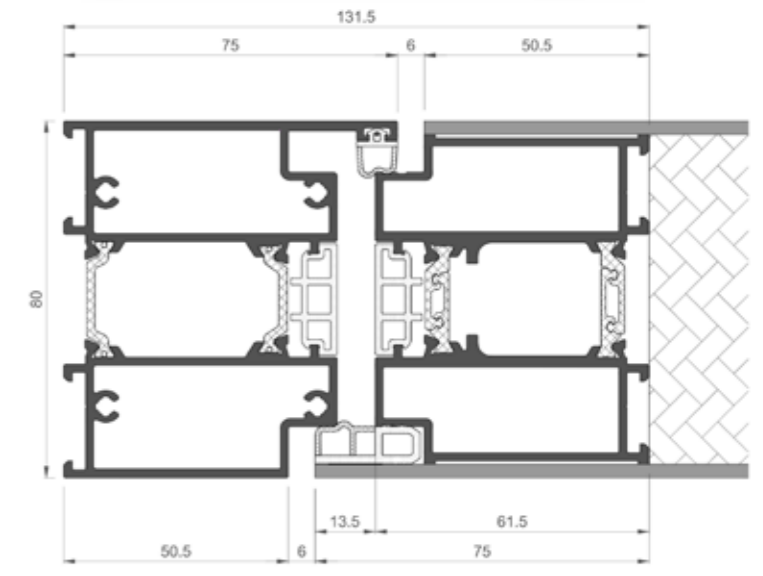



DOORBLOCK SYSTEM

COMPLETE BONDED DOOR SYSTEM ON BOTH SIDES

All DOORBLOCK doors come with the following basic features:

- 70 / 80 mm thickness profile
- 70 / 80 mm thickness panel
- 2'5 mm THICKNESS ALUMINIUM SHEET
- FLUSH PANEL WITH FRAMES BOTH SIDES
- 3 POINTS LOCK
- VISIBLE HINGES (at least 3, powder painted in the color of your choice, except woodgrain)
- Glass thickness for sidelights: 24 mm and 40 mm (Consult other values)
- Core EPS ($d=30 \text{ kg/m}^3$)
- Maximum door height: 3.000 mm with visible hinges
2.700 mm with hidden hinges
- Maximum door width: 1.800 mm with visible hinges
1.500 mm with hidden hinges
- Aluminium frame and panel in powder paint finish
- Solid panel or panel with triple laminated glass and double chamber for better insulation
- Thermal seal with shear-free insulating profile (page 5)
- Safety cylinder
- Low threshold in between the side frames
- Lever handle
- Air permeability: **CLASS 2**
- Watertightness: **CLASS 2A**
- Wind resistance: **CLASS C4**
- Impact resistance: **CLASE 5**
- Maximum acoustic insulation: **Rw-28 (-4; -4) dB**
- Thermal transmittance: **Uw-11 W/m²K**

Optional extras:

- Motorized lock, with different types of electronic opening available: fingerprint, bluetooth, code... (page 57)
- Handle: concealed (page 44), from catalogue (page 59), customized...
- Hidden hinges (at least 3) (page 62)
- High safety cylinder (page 63)
- Thumbturn (page 63)
- Hidden anti-lever system (page 63)
- Hidden door closer (page 65)
- Motorised opening (page 65)
- Electronic or digital wireless spyhole (page 65)
- Double door
- Sidelight: glazed, paneled, bonded...

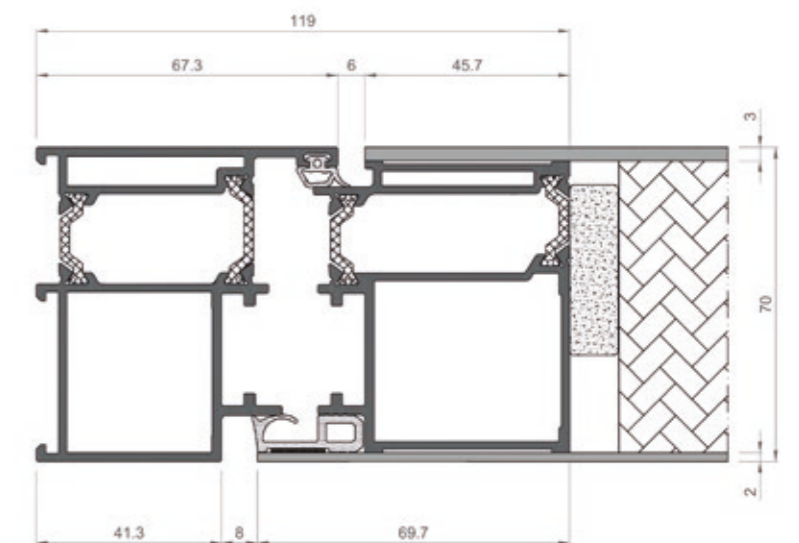

DOOR THRESHOLD:

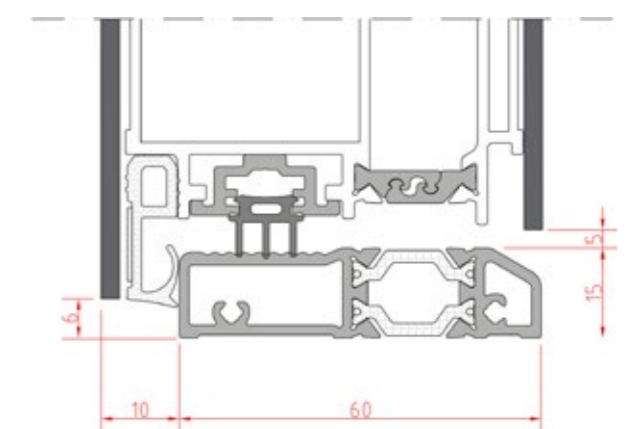



4LINE GLACIAR
 Colour: RAL 7016
 Accessory: MA 13
 Details: Stainless steel

SHEAR-FREE INSULATING PROFILE

Minimizes the longitudinal expansion produced by the outside-inside temperature difference

This polyamide keeps the door in perfect shape even when there are extreme differences between the external and internal temperature. It consists of two intermeshing parts which, with temperature-related, differing linear expansion of the inner and outer shells, the two parts move against one another.

This generates a moveable, corrective insulating zone which minimises the bi-temperature effect and reduces deformation effectively.

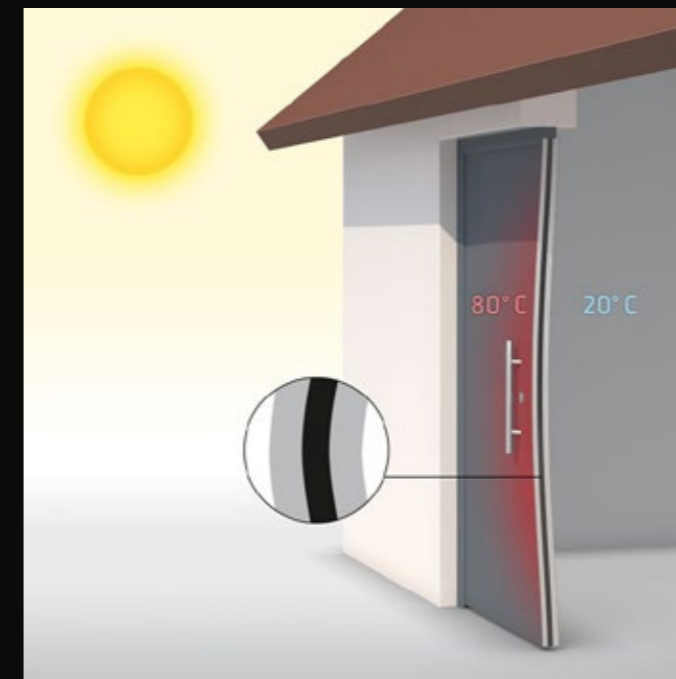

In an aluminium assembly with a conventional insulating profile, the large temperature difference causes the door to become deformed.

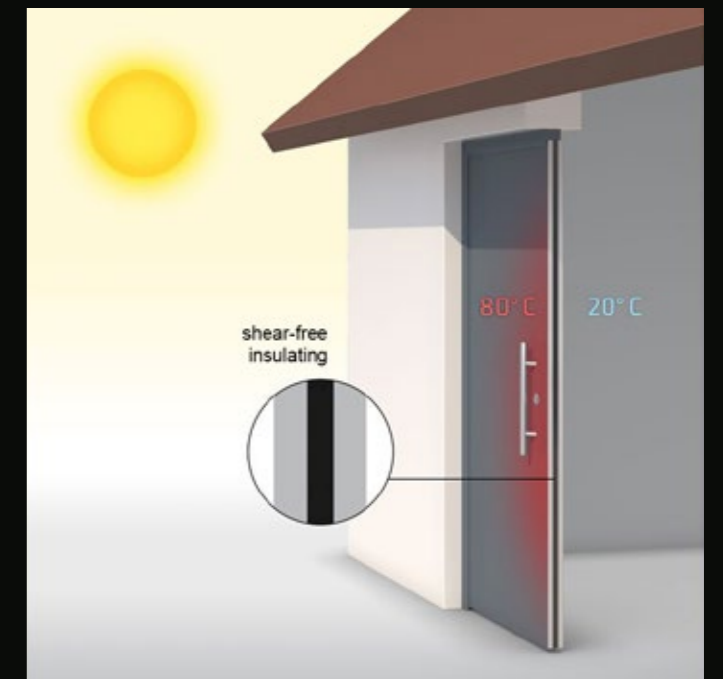

When the shear-free insulating profile is used, the differing linear expansion values of the inner and outer shells are evened out effectively.

BENEFITS:

- No shear: minimization of the bi-temperature effect compared to flexible and rigid profiles to shear
- Minimum elastic shear stiffness c and low shear strength T
- Optimized geometry for high transverse tensile strength Q
- Can be assembled and coated as a traditional insulating profile

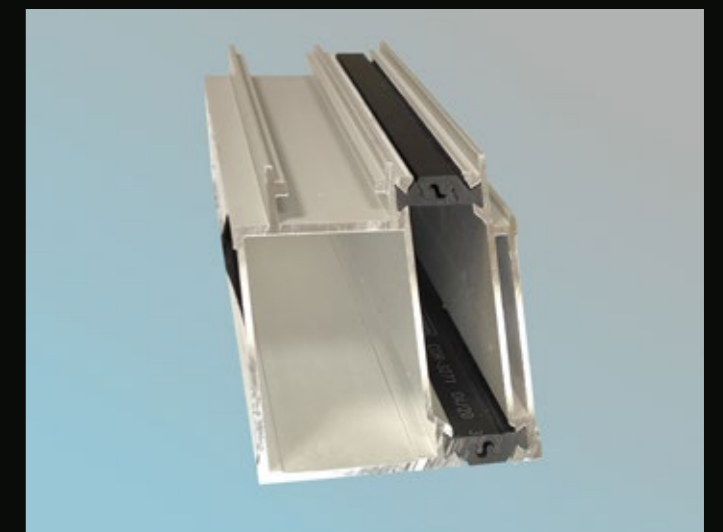



7LINE
Colour: Foil 20057005 Montain Oak
Accessory: MA 13

- ① ALUMINIUM PANEL, 70 OR 80 mm THICKNESS FRAMES, BONDED ON BOTH SIDES, WITH 2'5 mm THICKNESS SHEET
- ② ALUMINIUM FRAME WITH THERMAL SEAL AND SHEAR-FREE INSULATING PROFILE
- ③ RECESSED HANDLE AND INTERIOR/ EXTERIOR ACCESSORIES (LEVER HANDLES AND BAR HANDLES)
- ④ MULTIPOINT SECURITY LOCK
- ⑤ AUTOMATIC OPENING SYSTEMS (FINGERPRINT, BLUETOOTH...)
- ⑥ DOOR LOW THRESHOLD
- ⑦ TRIPLE LAMINATED GLASS AND DOUBLE CHAMBER
- ⑧ VISIBLE OR HIDDEN HINGES
- ⑨ SAFETY CYLINDER
- Ⓞ ANTI-LEVER SYSTEM



MOD. LO5

Yolodoor

THE SMART DOOR THAT RECEIVES YOUR ONLINE PURCHASES

Yolodoor is the first smart door that integrates into any home, offering freedom, comfort and security. It is connected to your smartphone so you have total control over your home.

- You will be able to receive your purchases at home.
- Return your purchases without waiting.
- Open the intercom from the app.
- Open without keys.
- Give access to family and friends.
- Connect your integrated alarm.
- Open your garage door.

① GATE

Security sliding gate for parcel reception 290X470mm

② PLATFORM

Motorised folding platform with a load capacity of up to 10kg

③ FINGERPRINT READER

Fingerprint reader integrated in the door handle.

④ SMART INGOT

The heart of the door. A smart ingot of galvanised steel with Yolodoor technology.

⑤ ELECTRONIC LOCK

Motorised electronic lock, with digital and analogue opening, with three-point security.

⑥ SAFETY SENSORS

Proximity security sensor with volumetric presence alert and alarm.

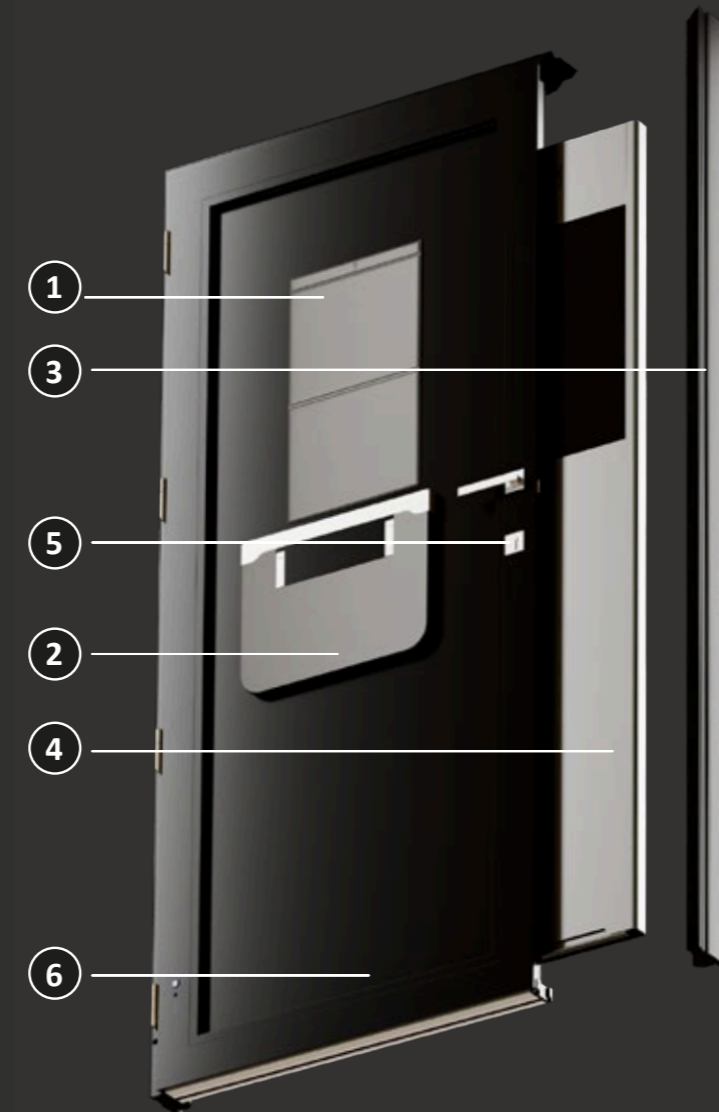



BASIC
 Colour: RAL 9005
 Accessory: TAURO



NEW

TAURO EMBEDDED HANDLE

FINISH OPTIONS:

- DEKTON
- LACOBEL
- RAL
- FOIL...

- FINGERPRINT OPTIONAL
- LED LIGHTING OPTIONAL

OPENING SYSTEMS

FINGERPRINT SCANNER

- Up to 20 users
- Light ring to signal system feedback and operating modes
- Installed in the door leaf or handle
- Available in stainless steel gray or black
- Freedom to leave the house and open the door without having to carry the key, smartphone, card, etc.
- Highest security: only authorised persons can unlock the door
- Highest level of counterfeit protection
- Recognizes the growth of children's fingers and changes in user habits as well as minor injuries
- Temporary access authorizations possible
- Access log shows all activities of the last 30 days
- Possibility of unlocking the door, via smartphone, from anywhere
- Message to the smartphone when opening the door
- Connection with the Alexa virtual assistant from Amazon



FINGERPRINT / KEYPAD OPENING N

- Storage for up to 100 fingerprints, 150 number sequences, and 1,000 RFID tags
- LED Indicator for authorized access
- Installed on the door leaf. Dimensions: 24 x 78 x 16 mm (W x H x D)
- Mobile app for access control, with immediate push notifications for each entry
- Self-learning for changing fingers (children, injuries, etc.)
- Remote opening from any distance
- Access authorizations by day and time, or for single use
- External relay unit for burglary protection
- Compatibility with Alexa and Google Home



CAMERA DOORBELL N

- Device with integrated doorbell, fingerprint reader, video camera, and intercom
- Storage for up to 100 fingerprints, 150 numeric codes, and 1,000 RFID cards
- Built-in Wi-Fi (allows remote door opening and closing via mobile app)
- Installation on door or wall
- Camera with night vision function
- Built-in intercom
- Comprehensive protection and security against manipulation
- Dimensions: 55.7 x 132.4 x 20.4 mm (W x H x D)

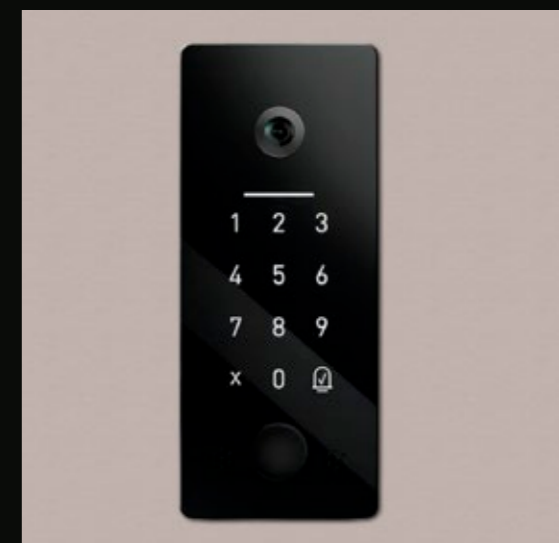



BASIC
 Colour: RAL 9005
 Accessory: MA19

BAR HANDLES

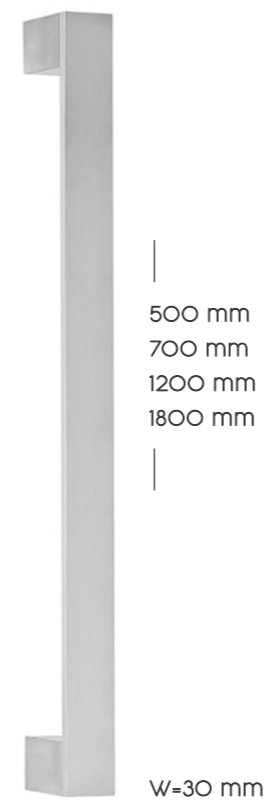

MA 4_Steel



MA 5_Steel

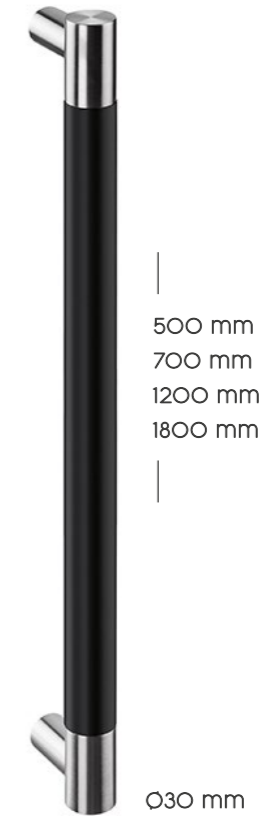

MA 8_Steel

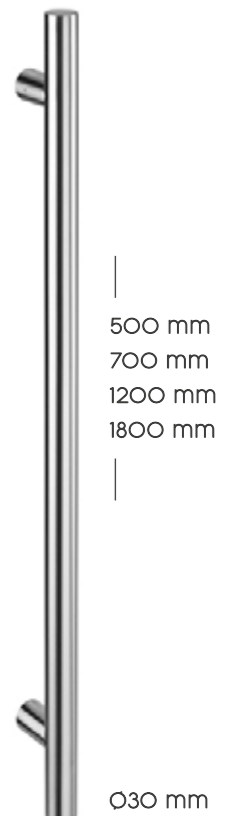

MA 10_Steel

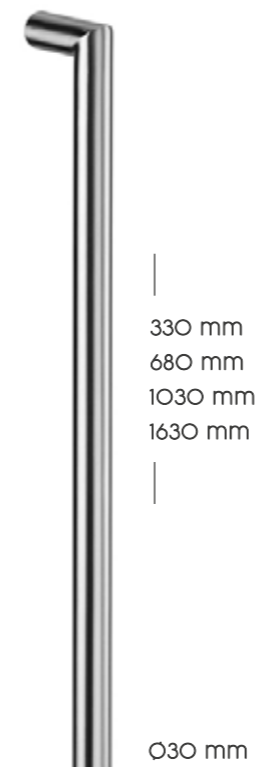

MA 11_Steel

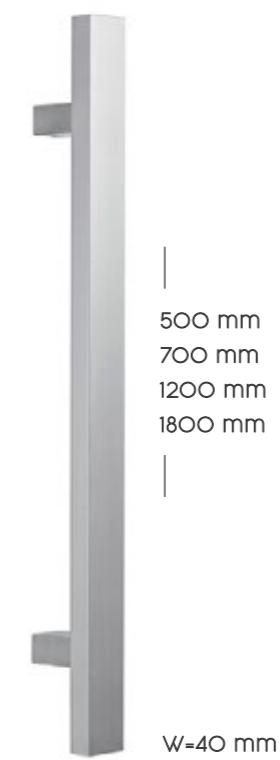

MA 13_Steel



MA 18_Steel
 300x150 mm



CASIOPEA_Steel
 1625x75 mm

* Available in satin and bright steel Consult other finishes

LEVER HANDLES



SQ 9_Satin steel



SQ 11_Black



SQ 12_Satin nickel N



SQ 13_Combined nickel N



SQ 14_Satin nickel N



Steel



SQ 15_Nickel N Graphite



SP 1_Bright chrome



SP 2_Satin chrome



SP 3_Bright chrome / Wengué

(IN)



SP 4_Bright chrome



SP 5_Cooper



SP 6_Bronze



SP 7_Anthracite



SP 9_Bright chrome / Brown leather

(IN)

● ● ● ● Consult other finishes

(IN) No outdoor treatment

KNOBS



PM 1_Satin steel
080 mm



PM 1_Black



PM 10_Satin steel
100x400 mm



PM 11_Satin steel
100x200 mm



PM 14_Satin steel
70x70 mm



PM 17 - Black
- White
- Nickel
- Slate stone

● ● ● ● Consult other finishes

EXT. KEYHOLE



BOC 11_Black



BOC 1_Satin steel
050 mm



_Black



BOC 2_Satin steel



BOC 6_Satin steel
50x50 mm



BOC 7_Satin steel
50x30 mm



BOC 10_Satin steel



BOC 12_Steel N _Graphite

● ● ● ● Consult other finishes

INTERIOR KEYHOLES

BISAGRAS



TWO-LEAF HINGES

- Supported leaf weight: up to 100 kg (with 3 hinges)
- Consult options for more weight



THREE-LEAF HINGES

- Indicated use for doors with a height greater than 3 m
- Supported leaf weight: up to 130 kg (depending on height)
- Consult options for more weight

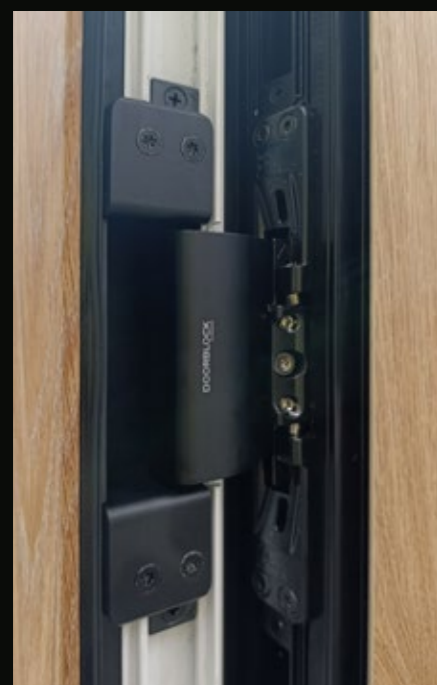

HIDDEN HINGE

- Best highlighting of the door design
- Adjustable in 6 directions
- Maximum opening angle 105°
- High security level
- Maintenance-free
- Includes thermal break
- Supported leaf weight: up to 180 kg
- Consult options for more weight

CYLINDER LOCKS AND SECURITY SYSTEMS



STANDARD SAFETY CYLINDER

- Double profile
- Flat nickel-plated brass key with 6 pistons
- Anti-drill bar in the cylinder body
- 30° DIN cam
- Property card
- Standard security level

HIGH SAFETY CYLINDER (OPTIONAL)

- Double nickel-plated European profile
- Double function (opening with key inserted) (OPTIONAL)
- Encryption with 14 pistons
- Reversible nickel silver key
- Registered and protected key profile
- Bumping resistant
- Drill protection on body and rotor
- Stainless steel encryption pistons
- Anti-extraction bar
- 30° DIN cam
- Property card

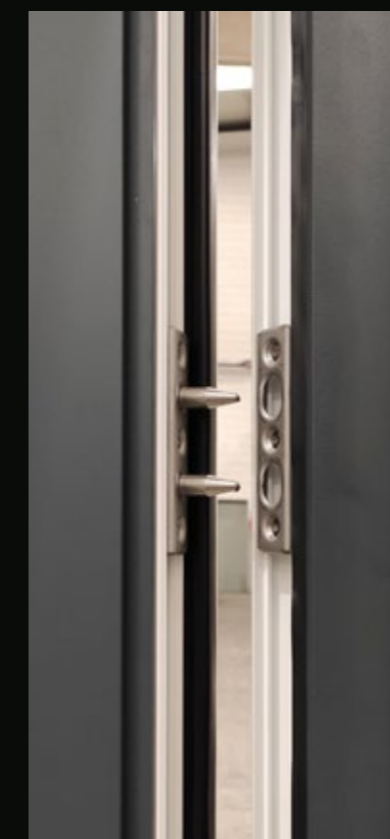

HIDDEN ANTI-LEVER SYSTEM

- Anti-lever safety lock with double reinforcement hinge

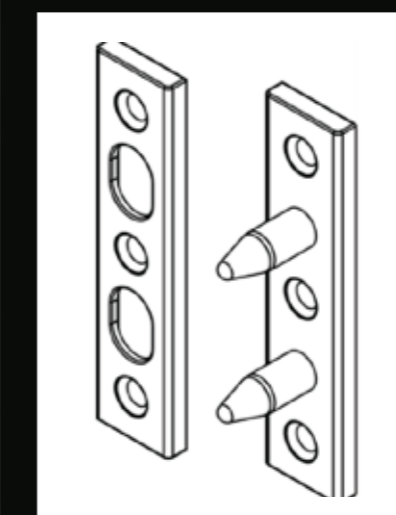

THUMBTURN

- This cylinder protects against unwelcome visitors, with a 11 pin reversible key system, it has been designed to withstand tampering techniques such as bumping, picking and drilling. Furthermore, it's equipped with a special anti-snapping bar in harmonic steel, designed to increase resistance to breakage or extraction.



AUTOMATIC LOCKS



MOTORIZED OPENING

- Easy-access door system
- Manual or automatic activation option (fingerprint, code, app, etc.)
- When the lock is activated, the deadbolts retract, unlocking the door

ACCESSORIES



ELECTRONIC SPYHOLE

- 3.2 inch digital spyhole
- Good visibility even in low light conditions
- 105° viewing angle
- Easy installation and handling
- For panels from 24 to 100 mm thick
- Battery: 2x AAA batteries



ENTRY PHONE

Allows a temporary activation of the door, with simple one-handed operation or motorized unlocking



HIDDEN DOOR CLOSER

- Integrated door closers are fully housed inside the door leaf. The sliding guide is only visible when the door is opened. The strength and speed of closing, the hydraulic final stroke and the hydraulic damping on the opening can be conveniently adjusted during the installation.

Maximum weight: 180 kg
Maximum length: 1.400 m
Maximum opening: 120°

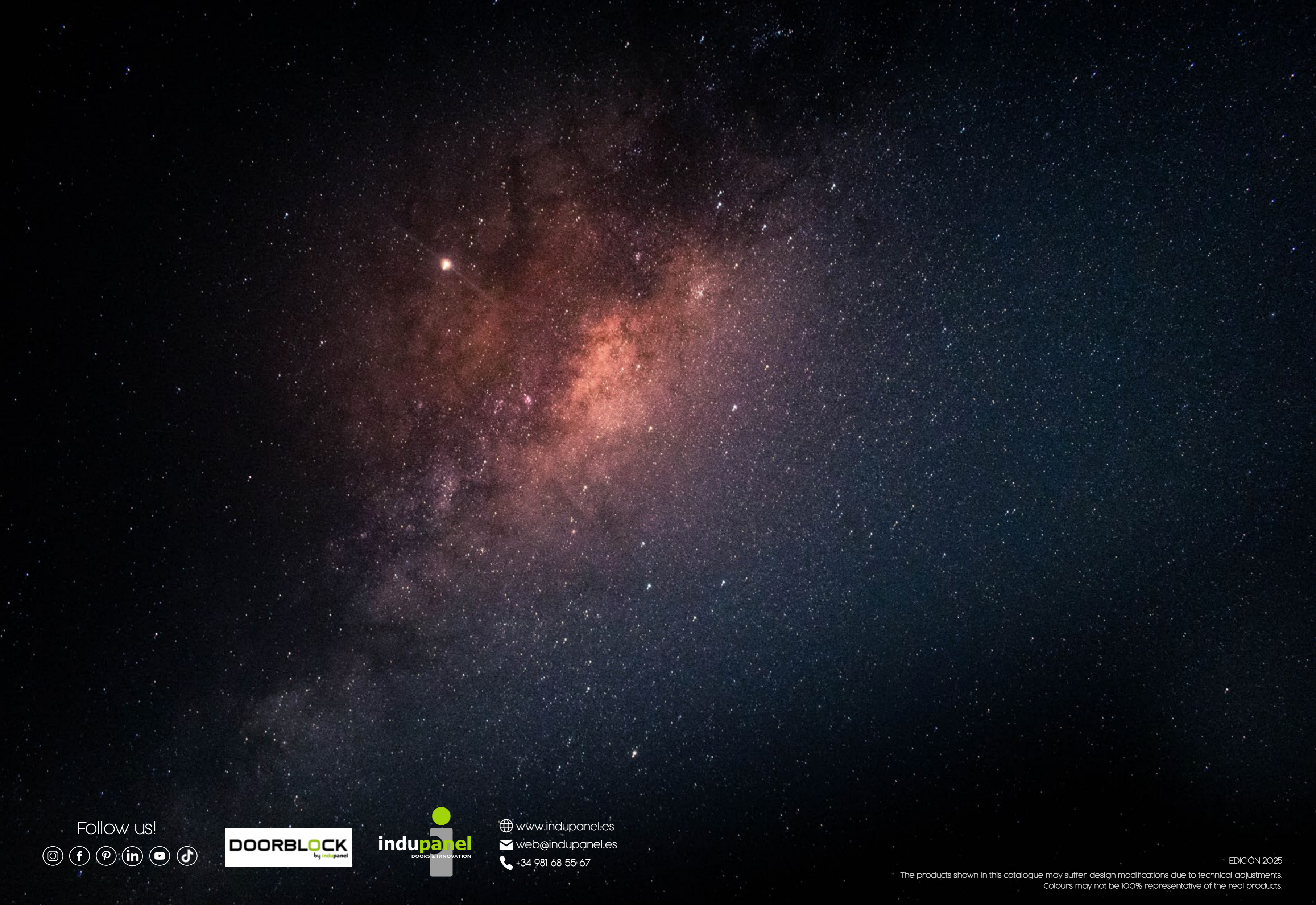

Follow us!



 www.indupanel.es
 web@indupanel.es
 +34 981 68 55 67

EDICIÓN 2025

The products shown in this catalogue may suffer design modifications due to technical adjustments.
Colours may not be 100% representative of the real products.